



RANGE AUGMENTATION FOR ONEWHEEL **VAMPIRE CONNECTION**

KIT CONTENTS:

- (1) RANGER™ mount
- (4) M5x14mm stainless screws
- (4) M5 low-profile nuts
- (1) 18" Vampire cable w/fuse
- (1) RANGER™ terminals cap
- (2) Rubber XT60 caps
- (2) Posi-taps
- (1) 3mm Allen key

TOOLS NEEDED:

- Power drill
- 3/16" (5mm) drill bit

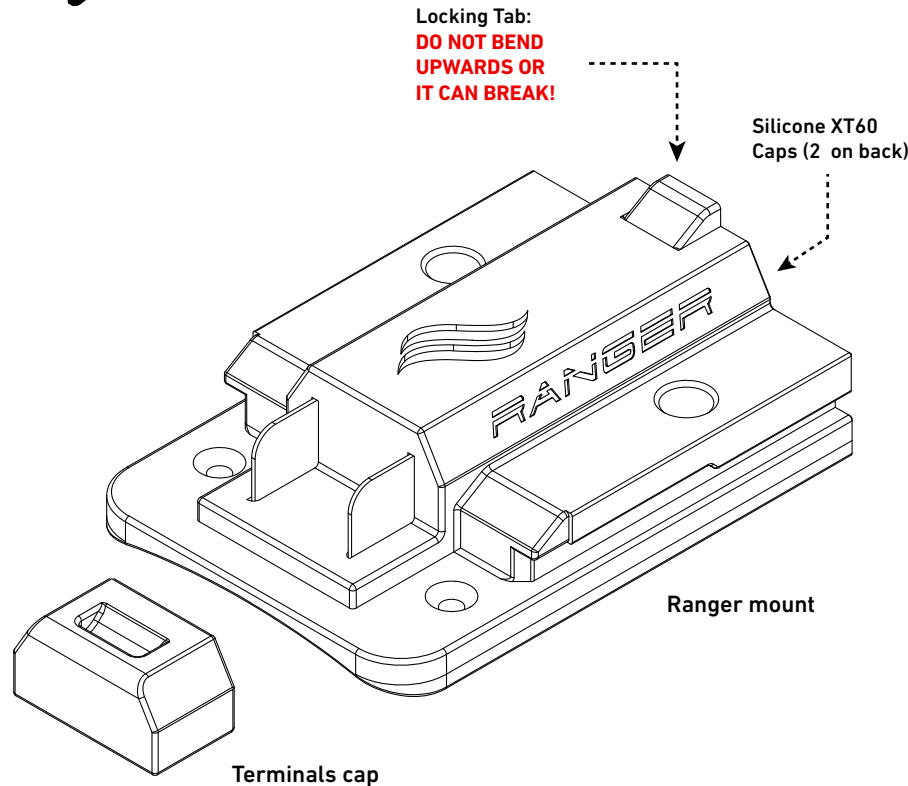

OVERVIEW & WARNING

The installation for the RANGER™ is straightforward. There are two main parts:

- STEP 1:** Install the mount somewhere on your fender (the lower the better).
- STEP 2:** Install the supplied cable using Positaps for Vampire Mode.

Realize you are dealing with significant voltages and the risk of shock is always present. Please work carefully and as safely as possible when working with live wires.

We recommend purchasing the EGO Rapid Charger (about \$99) to charge your EGO batteries quickly and safely. It's nearly twice as fast as the standard charger.

The RANGER™ is intended for use **ONLY** with EGO brand batteries in 2.0AH, 2.5AH, 5AH, and 7.5 AH (in a backpack) battery capacities.

Always use the EGO charger to charge the EGO batteries separately from your Onewheel.

DISCLAIMERS

Use this product at your own risk. Electric shock may occur. Misuse can result in electric shock, injury or death. By using this product you agree to hold the designer and manufacturer (Land-Surf, LLC) harmless and free from any liability.

ALSO...

This design is patent-pending and protected by copyright law. EGO® is a registered trademark of Chevron, Inc.

Designed in Marin, California



INSTALLATION

TIME TO COMPLETE: 30 MINS



Don't rest the EGO battery on the footboard.
Give it at least 1/4" clearance. Make sure the mount wires exit on the same side as the board's power button (left side).

1. CHOOSE A POSITION FOR THE RANGER MOUNT

Start with the fender on your board. Put an EGO battery of the largest size you intend to use on the Ranger™ mount. Then find a position that works for you, but don't let the battery "sit" on the rear footpad, as this will make it hard to remove for charging. Make sure the wires from the mount exit on the left side of the board (same side as the power switch).

The closer you can mount the battery to the rear footpad, the less effect the weight will have on the handling from a shift in CG. Also make sure to center the EGO battery (**not just the mount**) between the **left and right** sides of your board.

Then mark the chosen position of the mount on the fender using a pen or tape. Then remove the EGO battery from the Ranger™ mount, and place the Ranger™ back in position on your fender.

There are 4 holes in the Ranger™ mount for the included screws to go. Mark and drill those holes into your fender (remove the fender first). Then use the 4 included M5 x16mm flathead screws and low-profile washers to secure the mount to the fender. The hex key is a 3mm size. Tighten each screw snugly.

You can leave the fender off for the next step.



Center left to right on board. Make sure the mount's wires are facing the left side of the board.



2. PREPARE THE BOARD FOR THE VAMPIRE CABLE

Now that the Ranger mount is on correctly, remove the following from your board to make installation easier:

- 1) Fender
- 2) Footpad
- 3) Connector Access Panel (small panel on the underside near the wheel - 2 screws need to be removed).

Once exposed, the installation will be easier to complete in a neat a tidy way. The front of your board should now look like the picture at left. The vampire cable installation can be done from the top side of the board.

NOTE: New kits have a 30-amp fuse wired into the positive (red) wire of the VNR cable. Installation is the same as shown here – the fuse is just a safety precaution that we've just added for extra security.



Top view of board, ready for cable installation.
Footpad, fender, and connector access panel are shown removed.

INSTALLATION CONTINUED

3. ATTACH POSI-TAPS TO POWER LEADS

Find the two Posi-taps included with your kit. Unscrew the large end on each Posi-tap. Then place each one onto the power leads as shown. One goes on either red cable, and one goes on either of the black cables.

Then screw on the main body of each Posi-tap, and tighten fully. Now you should have one Posi-tap on the a red cable, and one on a black cable (see the middle picture below).



Put a Posi-tap large end on either red wire, and another Posi-tap large end on either black wire.



Screw on the body of the Posi-tap tightly to each end.



Once both Posi-taps are installed it will look like this. Note the other ends have been removed for the next step.

4. CONNECT ENDS OF WIRE TO POSI-TAPS

Grab the cable included with your kit. Remove the shrink-wrap tubing from the end without the XT60 (yellow) connector, and expose the wires. Now take the small ends from the Posi-taps and run one of the wires of the cable into each. Then insert the exposed end of the wire into the Posi-tap you just installed above.

CONNECTIONS

RED WIRE IN CABLE → RED WIRE ON ONEWHEEL
BLUE WIRE IN CABLE → BLACK WIRE ON ONEWHEEL



CAUTION! CHECK POLARITY!

IF YOU SWAP POLARITY THERE WILL BE SPARKS WHEN YOU CONNECT THE EGO! CHECK TO MAKE SURE YOU HAVE IT RIGHT.

INSTALLATION CONTINUED



Small zip tie here

5. RUN VNR CABLE OUT AND ALONG THE RAIL

Now you simply need to route the cable so that it follows the motor cables out of the connector box (no holes to drill here). Route the cable as shown at left, and use the included zip ties (the smaller ones) to make the VNR cable follow the curve of the motor cable. This way, when we reinstall the connector panel cover, it will go on easily.

Reinstall the underside control box connectors panel, and make sure the wires are all contained inside and are not pinching anywhere. Then reinstall your footpad and fender.

Use the included large zip ties to secure the wire along the rail, back towards the Ranger mount. Tuck it in and keep it from getting damaged in a crash.

6. NOW, GO RIDE 2X or 3X YOUR NORMAL RANGE!

Note: when a battery is not mounted, use the Terminals Cap to keep the terminals on your Ranger™ from getting tarnished, dirty, or bent.

To power on, make sure the EGO battery is fully on the Ranger mount. Turn on the Onewheel's power button first, **then** connect the XT60 Plug between the Ranger and the Vampire cable.

To power off, unplug the XT60 Ranger cable and then turn off the Onewheel with it's power button.

Basically, turn the Onewheel on first, and off last.



Install the included XT60 Silicone cap (provided on the back of the Ranger mount) over the end of the XT60 connector, if not connected to the VAMPIRE cord.

Store it on the back of the Ranger mount to keep it from getting lost.

CHANGING BATTERIES

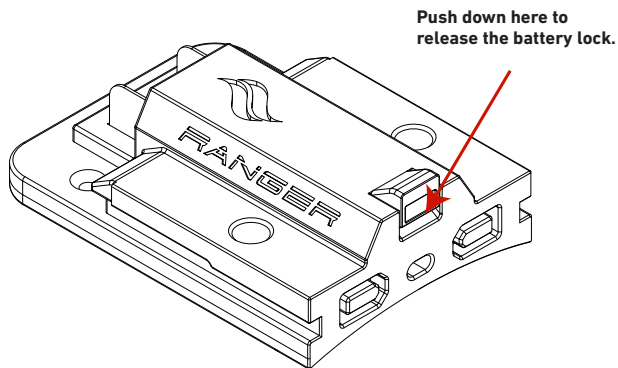

Your Ranger™ comes with a new locking feature to keep the EGO battery on the mount until you want to remove it for charging. To release the battery, pull down on the loop on the back of the mount where indicated (see diagram).

While holding the loop down, slide the battery off the mount.

Slide a fresh battery on and the lock will engage automatically.