

STEALTH™

SIDE HANDLE FOR ALL ONEWHEELS

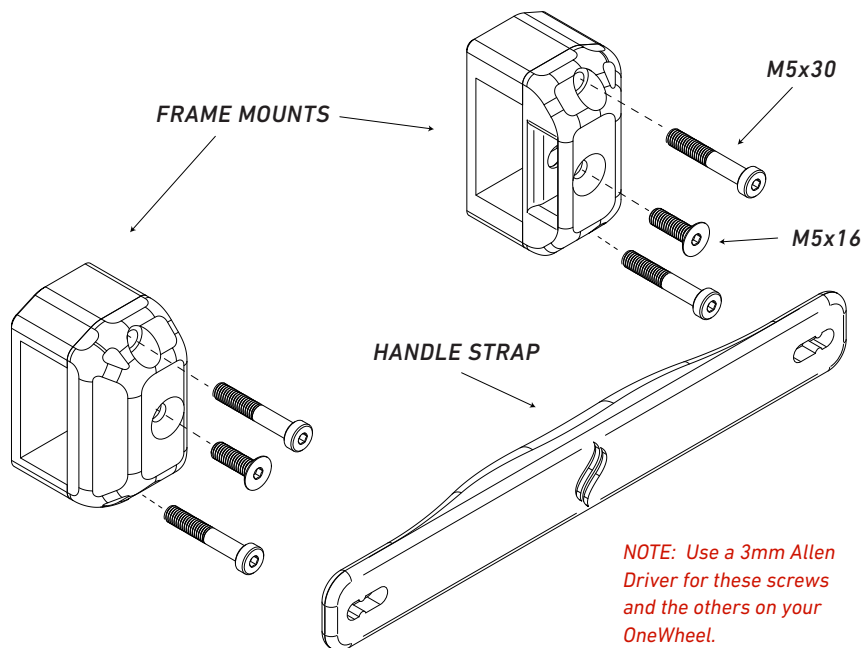

KIT CONTENTS:

- (1) Handle strap
- (2) Frame mounts
- (4) M5x30mm steel screws
- (2) M5x16mm steel screws
- (4) M5 steel nuts

TOOLS NEEDED:

3mm Allen driver

SIDE KICKS USERS NOTE:

To install on a board with Side Kicks, you must remove the top and bottom Side Kicks pieces. Next, install the handle. Then, cut the top and bottom Side Kicks pieces into three parts, to fit in between and around the mounts.

DISCLAIMER - READ!

No warranty implied or offered. However, this thing is tough!

The strap is a replaceable product. It will last a long time, but if it starts to get beat up, you can grab a new one from our site without buying new mounts.

Use this product at your own risk. Misuse can result in injury or death. By using this product you agree to hold the designer and manufacturer (Land-Surf, LLC) harmless and free from any liability.

Do not hold the handle while riding. You can scrape your fingers and get a boo-boo, or worse.

Basically, don't be stupid. Ride safely and within your ability.

ALSO...

This design is patent-pending and protected by copyright law. Please don't steal the design and sell it. That's bad karma. Designed and 3D printed by Land-Surf, LLC, in Marin, California.

CONGRATULATIONS!

You now own the finest handle available for your OneWheel!

This new STEALTH™ handle has been specifically designed for the OneWheel. It stows away while riding, and a simple sharp pull on it will expand the strap outwards and lock it into place. To retract, simply push the strap back in.

Mount the handle on either side of your OneWheel.

To install, separate each mount half and put the back sides under the rail, close to the axle. There isn't a lot of room between the wheel hub and the rail, so you may have to wiggle it around a bit. Once in place, put on the front part of each mount and the long screws, but do not tighten fully. Then take your strap and put it in both mounts - with the flat side facing outward. Put a short strap screw in each mount to keep the strap in place (don't tighten yet). Move the entire assembly so that it's centered on your board. Push the mounts towards each other to take up any slack. Then while holding the mounts in place, tighten each of the long screws. **Then tighten the strap screws, but only go finger-tight, as going too far can damage your mount.** Then test it all by grabbing the strap and pulling on it sharply. It should "pop" into place and stay there. If the mounts move at all during the handle pop-out, tighten them a bit more.

May your journeys be free of incident, and your rides long.

- Matt Hoover

LAND  SURF™
land-surf.com